

Introduction

- To use the CPMS 2.0, two actions need to be completed:
 1. Create an EU Login account with 2-factor authentication activated
 2. Request access to CPMS 2.0
- Follow the steps in this guide to be able to use CPMS 2.0

CPMS 2.0 Homepage



CPMS 2.0



Click here to **create an EU Login account**

CPMS 2.0

Clinical Patient Management System

Login

To access this system, you need an EU Login account.
Click [here](#) to create one, if needed.

Click here to log in or **request CPMS access**

Clinical Patient Management System (CPMS)

The CPMS is a secure and fully GDPR compliant IT platform aiming to facilitate the cross-border discussion of rare clinical cases.

The platform is supervised by the Directorate General for Health and Food Safety (DG SANTE) of the European Commission and funded under the EU4Health Programme.

The CPMS 2.0 is open source, distributed under the EUPL license.

[Privacy Policy](#)

About Us

The European Reference Networks (ERNs) are cross-border networks that bring together EU reference hospitals to tackle rare, low prevalence and complex diseases and conditions requiring highly specialised healthcare.

[Cookies](#)

Help & Support

[Getting set-up and logged into CPMS 2.0](#)

[EU Login dual factor authentication set-up](#)

[Frequently asked questions](#)

[Supporting documents](#)

Contact Us

Sante-ERN-CPMS-itsupport@ec.europa.eu

EU LOGIN

Create EU Login

Go to the EU Login sign-up page

<https://webgate.ec.europa.eu/cas/eim/external/register.cgi>



Enter your details to create an account →

Create an account

[Help for external users](#)

First name

Last name

E-mail

Confirm e-mail

E-mail language

By checking this box, you acknowledge that you have read and understood the [privacy statement](#)

Create EU Login

→ You will receive a confirmation email

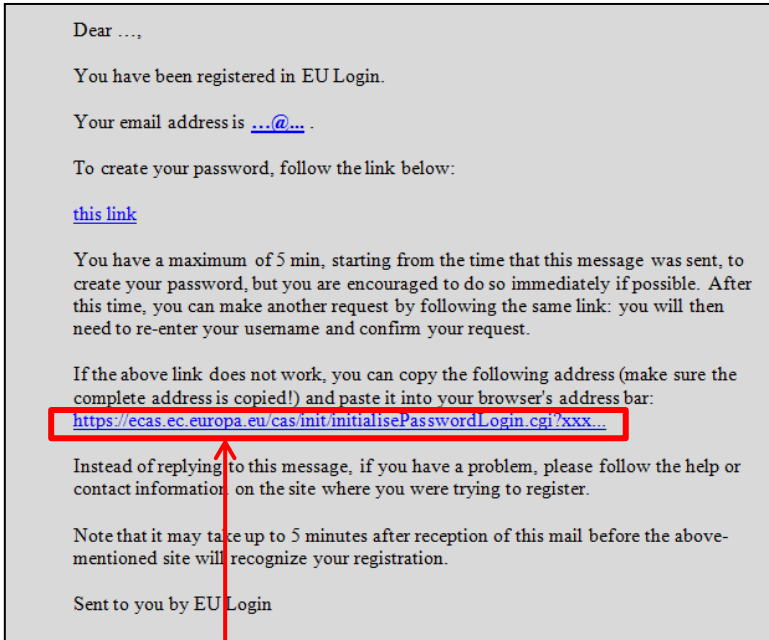

Click on this link in the email to set your unique password

New password

! Please choose your new password.

n...
(External)

New password

Confirm new password

Submit

Passwords cannot include your username and must contain at least 8 characters chosen from at least three of the following four character groups (white space permitted):

- Upper Case: A to Z
- Lower Case: a to z
- Numeric: 0 to 9
- Special Characters: !"#%&'()*+,-./:;<=>@[|^_`{}~

Examples: SEN5RbaW GwOzMg9m U(nuCuwh

[\[Generate other sample passwords\]](#)

2-Factor Authentication

- To use **2FA** (2-factor authentication) with your EU Login Account, a **Mobile Device** needs to be **linked**
- Additionally, the **EU Login App** needs to be **installed** on your phone and **initialised**

Download the EU Login app on your Mobile Device

Search for „EU Login“ on your mobile device’s app store or go to one of those links

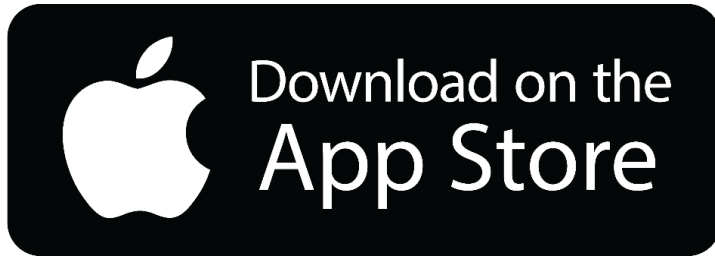

Add a Mobile Device to your EU Login Account

Log in to EU webgate with EU login credentials
(email and password) <https://webgate.ec.europa.eu/cas>



Sign in to continue

Enter your email address or unique identifier

[Create an account](#) **Next)**







Or

If you do not wish to create an EU Login account, you can sign in by using one of the following third-party sign-in options ("Sign-in Service"). [Read more](#)

-  [Sign in with your eID](#)
-  [Sign in with Facebook](#)
-  [Sign in with Google](#)

Sign in to continue

Welcome

-  **Trusted Platform or Security Key**
Use a Trusted Platform or Security Key to authenticate with EU Login.
-  **EU Login Mobile App PIN Code**
Use your registered EU Login Mobile app to verify your identity.
-  **EU Login Mobile App QR Code**
Generate a one-time-password with the EU Login Mobile app.
-  **Token**
Use a VASCO token to generate a one-time-password to login.
-  **Token CRAM**
Use a CRAM token to generate a one-time-password.
-  **Password**
Authenticate to EU Login with only your password.
-  **Electronic ID (eID)**
Use your registered electronic ID (eID) to verify your identity.

Easy, fast and secure

Download on the App Store

Add a Mobile Device to your EU Login Account

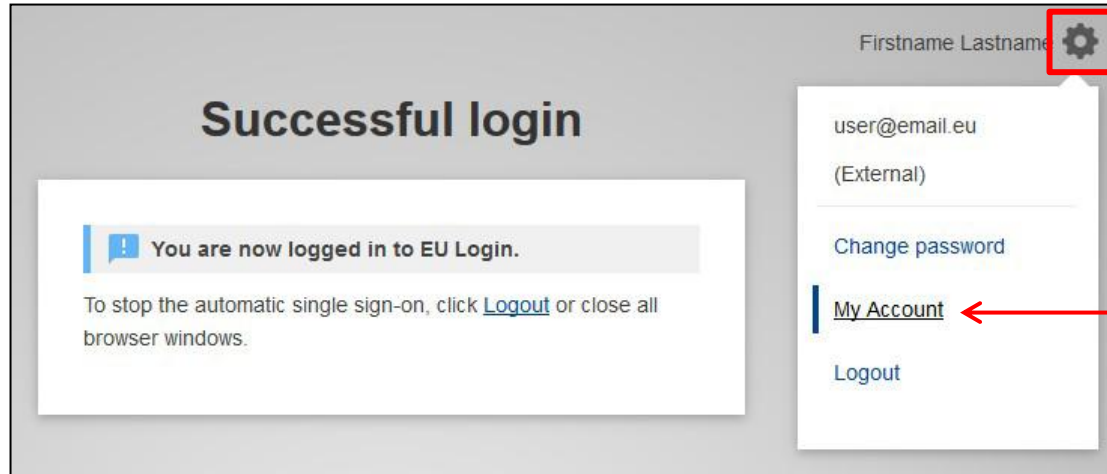

Hover mouse over
the gear symbol



Click on "My Account"

Add a Mobile Device to your EU Login Account

At your account page, go to “Manage my mobile devices” and add your phone

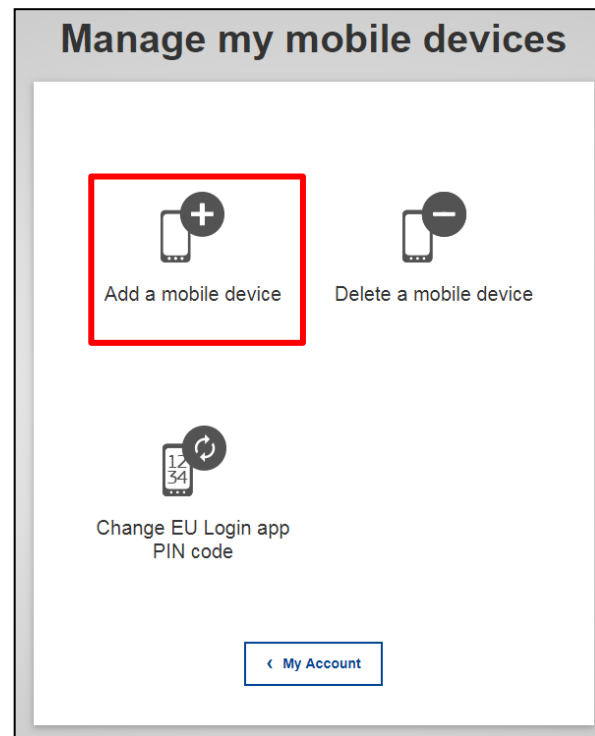

Add a Mobile Device to your EU Login Account

Fill out the fields and click submit

Add a mobile device

Please give a name to identify your mobile device and a PIN code to use for it.

Your device name

Your 4 digit PIN code

You will be required to enter this PIN code on your mobile device to use the EU Login mobile app.

Confirm your PIN code

Choose something easy and obvious, like „Work Phone“

Choose a PIN for future use

Repeat the PIN here

Submit (this will generate a QR code that is needed to initialise the EU Login App, see following pages)

Initialise the EU Login App

After you have submitted your PIN, a QR code will be generated on the computer you are using. You will need to scan this QR code in the EU Login App to initialise it, as described on the following pages.

If you already have a mobile device connected to your EU Login and only want to initialize the app, you may need to delete the device and add it again to get the QR code.

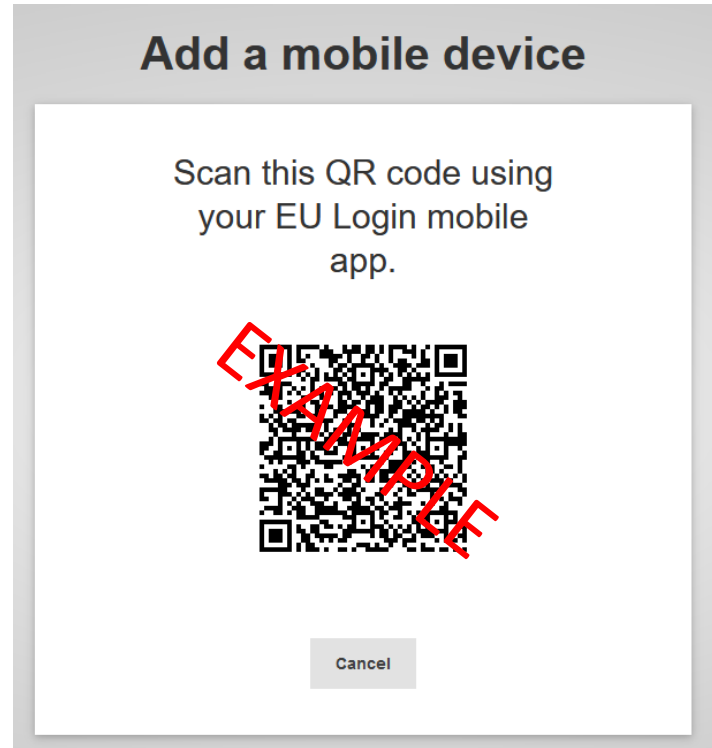

Initialise the App

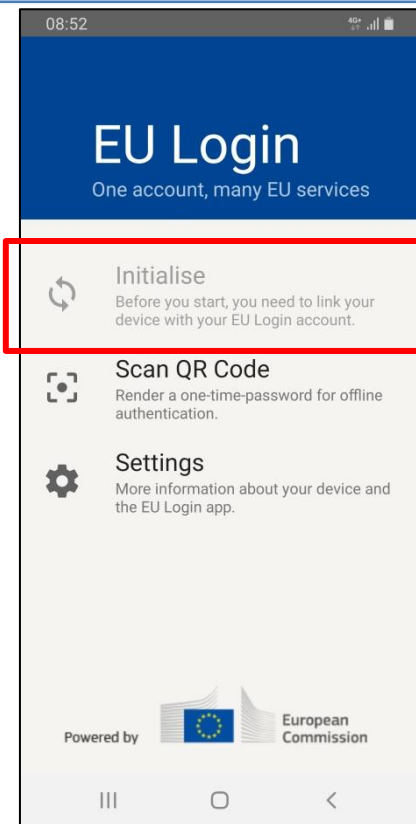

- In the EU Login app on your phone, select „Initialise“ to scan the QR code on your computer screen
- In the App, you will need to confirm the initialization with your PIN (created on page 14)
- You can now use the EU Login App

Add a mobile device

Scan this QR code using your EU Login mobile app.



Cancel

Using the EU Login App

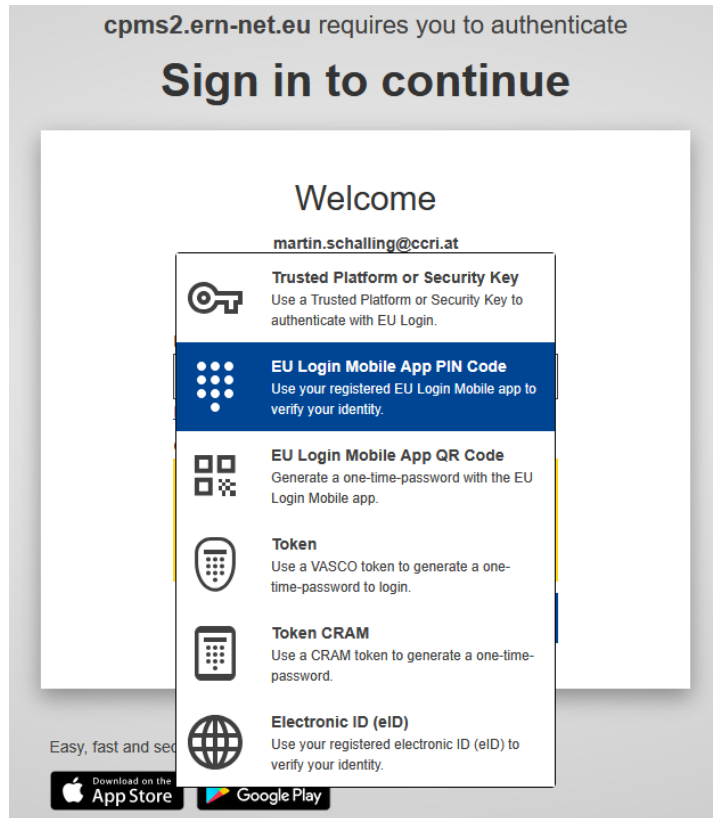

When logging in to EC IT services (CPMS), enter your password and select the option to use the [EU Login Mobile App PIN Code](#). When you do so, you need to open the app on your phone to put in the PIN you chose when setting up your EU Login account.

It might take a couple of seconds for the login prompt to show up when opening the app.

If your phone uses biometrics (e.g. fingerprint, face recognition), this method can be chosen on the phone instead of entering the PIN.

CPMS 2.0 ACCESS

<https://cpms2.ern-net.eu/screen/home>



CPMS 2.0



CPMS 2.0

Clinical Patient Management System

[Login](#)

To access this system, you need an EU Login account.
Click [here](#) to create one, if needed

Click on Login



Clinical Patient Management System (CPMS)

The CPMS is a secure and fully GDPR compliant IT platform aiming to facilitate the cross-border discussion of rare clinical cases.

The platform is supervised by the Directorate General for Health and Food Safety (DG SANTE) of the European Commission and funded under the EU4Health Programme.

The CPMS 2.0 is open source, distributed under the EUPL license.

About Us

The European Reference Networks (ERNs) are cross-border networks that bring together EU reference hospitals to tackle rare, low prevalence and complex diseases and conditions requiring highly specialised healthcare.

Help & Support

- Getting set-up and logged into CPMS 2.0
- EU Login dual factor authentication set-up
- Frequently asked questions
- Supporting documents

[Privacy Policy](#)

[Cookies](#)

[Contact Us](#)
Sante-ERN-CPMS-itsupport@ec.europa.eu

Sign in with EU Login credentials

EU Login
One account, many EU services

English (en)

WARNING | 06-05-2025
By 30 June 2025, authentication by SMS will stop. If you use this method, you must switch to a more secure alternative immediately to avoid disruption to your work. To configure another method, go to 'My Account' at the bottom of the page. For more details, see the 'Help' link below.

CPMS2 requires you to authenticate

Sign in to continue

Enter your email address or unique identifier



[Create an account](#) **Next >**

Or

If you do not wish to create an EU Login account, you can sign in by using one of the following third-party sign-in options ("Sign-in Service"). [Read more](#)

 [Sign in with your eID](#)

Easy, fast and secure: download the **EU Login app**

Here, fill in the email address from your EU Login account and click Next.

Sign in with EU Login credentials

EU Login
One account, many EU services

English (en)

WARNING | 06-05-2025
By 30 June 2025, authentication by SMS will stop. If you use this method, you must switch to a more secure alternative immediately to avoid disruption to your work. To configure another method, go to 'My Account' at the bottom of the page. For more details, see the 'Help' link below.

CPMS2 requires you to authenticate
Sign in to continue

Welcome back
(External)
[Sign in with a different email address?](#)

Password
.....
[Lost your password?](#)

Choose your verification method

EU Login Mobile App PIN Code
Use your registered EU Login Mobile app to verify your identity.

Sign in

Here, fill in the password from your EU Login account.

Choose **EU Login Mobile App PIN Code** as verification method and click Sign in.

Open the EU Login app on your phone to sign in.

Complete Profile

European Commission CPMS 2.0 - TEST

Public Page > Sign Up

Sign Up
Please complete these questions to re

Page 1 of 3

Which category best describes your role? ⓘ

Please select

Clinician Assistant

Are you a member of ERN? ⓘ

Please select

Yes No

Professional Information

Please select

Healthcare provider / hospital *

ERN * ⓘ

RITA PaedCAN

If you are located in an ERN member institution, select the options that are correct for you and click **Next**.

European Commission CPMS 2.0 - TEST

Clinician Assistant

Are you a member of ERN? ⓘ

Please select

Yes No

Professional Information

Please select

Healthcare provider / hospital *

Which ERN invited you *



<input type="checkbox"/> EURO-NMD	<input type="checkbox"/> ERKNet	<input type="checkbox"/> ERN-LUNG
<input type="checkbox"/> ERN-RND	<input type="checkbox"/> GUARD-HEART	<input type="checkbox"/> CRANIO
<input type="checkbox"/> EpiCARE	<input type="checkbox"/> BOND	<input type="checkbox"/> EURACAN
<input type="checkbox"/> ERNICA	<input type="checkbox"/> ITHACA	<input type="checkbox"/> TRANSPLANTCHILD
<input type="checkbox"/> MetabERN	<input type="checkbox"/> RARE-LIVER	<input type="checkbox"/> Endo-ERN
<input type="checkbox"/> ReCONNENT	<input type="checkbox"/> VASCERN	<input type="checkbox"/> RITA
<input type="checkbox"/> ERN-SKIN	<input type="checkbox"/> eUROGEN	<input type="checkbox"/> GENTURIS
<input checked="" type="checkbox"/> PaedCAN	<input type="checkbox"/> EuroBloodNet	<input type="checkbox"/> ERN-EYE

Working Country *

If you are a Guest (e.g. not located in an ERN Member institution), select **No** here, fill in the name of your hospital, select PaedCan and your working country.

If you are unsure about the ERN status of your hospital, refer to page 23.

Complete Profile

**CPMS 2.0** TESTMartin Schalling

[Public Page](#) > [Sign Up](#)

Sign Up

Please complete these questions to request access to New CPMS.

Page 2 of 3

Clinical Focus

Please enter some information about yourself and your areas of expertise.

Cares for *

Adult Pediatric

Profession *

Thematic Area *

Subthematic Area

In your own words, what is your specific clinical or research focus, for which you feel competent to give expert advice?

Please insert here, what is your specific clinical or research focus, for which you feel competent to give expert advice

[Back](#) [Next >](#)

Select the options that are describe your work profile and click Next.

Submit Access Request

European Commission CPMS 2.0 - TEST - Martin Schalling

Public Page > Sign Up

Sign Up
Please complete these questions to request access to New CPMS.

Page 3 of 3

Overview
Please review your information before submitting

1 Information from EU login

Name * Martin Schalling
Email * m.schalling@gmx.at
EU username * -

2 Professional Information

Role * Healthcare Professional
ERN * PaedCAN
Healthcare provider / hospital * St. Anna Kinderspital & St. Anna Kinderkrebsforschung

3 Clinical Focus

Cares for * Pediatric
Profession * Paediatrician
Thematic Area * Solid Tumour
Subthematic Area
Focus area -

Sign Out

Edit Submit access request

You can double check all the entries you have made. To go back, click on **Edit**.
To complete the process, click **Submit access request**.

Access Approval

- After submitting the request, the ERN PaedCan Helpdesk will review and rule any access request within 24 hours (not including weekends)
- In case of any issues or questions, you will be contacted via e-mail

ERN Search Tool

ERNs (1 / 24) **Countries (28 / 28)**

1 PaedCAN - Paediatric Cancer ▼ 28 AT - Austria, BE - Belgium, BG - Bulgaria, CY - Cyprus, CZ ... ▼

Filter priority on ERNs Filter priority on countries i

Legend:

- - ERN Member
- - ERN Associated National Centre
- - ERN Coordinating Clinical Centre
- - ERN National Coordination Hub
- - Multiple

If you do not know whether your hospital is part of an ERN, you can use the EC's ERN search tool to find out.

Find it at this link:
https://webgate.ec.europa.eu/ernsd/screen/public?npage=ern_portal.html#!/